

Interface Inc. claims proprietary rights in the information disclosed herein. This drawing is furnished in confidence on the express understanding that neither it nor any reproduction thereof will be disclosed to others or used for the purpose of manufacture or procurement of the article or part shown hereon without written permission of Interface Inc. The drawing shall remain the property of Interface Inc. and shall be returned upon request by Interface Inc.

80020

REVISIONS

REV	DESCRIPTION	DATE	APPROVED
C	BALLOON 12, 8.62 WAS 8.25	02/22/99	
D	8.75 OVERALL LENGTH WAS 8.62	06/04/08	
E	ADDED METRIC CAPACITIES	07/05/12	RLP

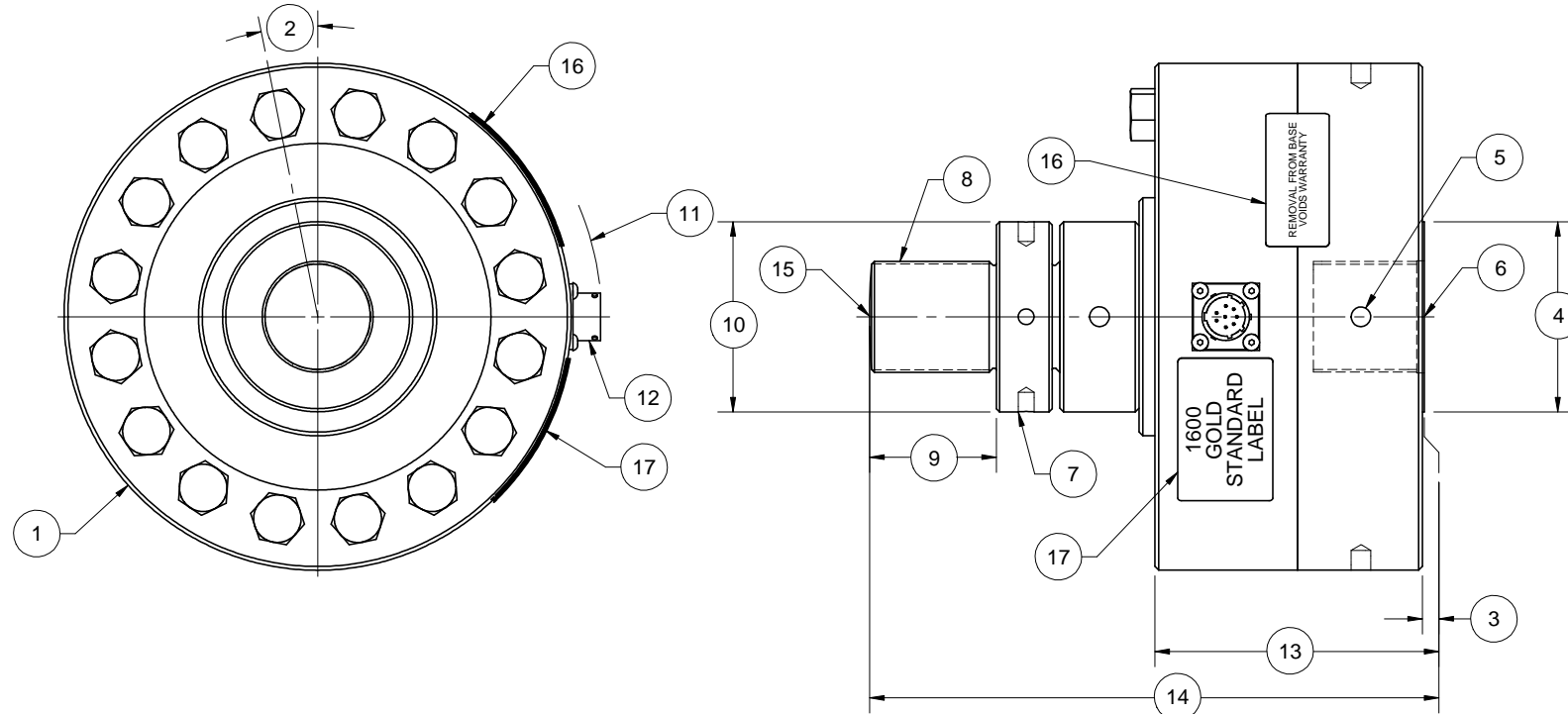

FLEXURE BASE

CONNECTOR PINOUT	
PIN	FUNCTION
A	+ EXCITATION
B	+ SIGNAL
C	- SIGNAL
D	- EXCITATION
E	- SENSE
F	+ SENSE
G	- RCAL
H	+ RCAL

TENSION UPSCALE

2. DIMENSIONAL TOLERANCE: ± 0.01 (± 0.3).

1. DIMENSIONS IN INCHES (mm).

LOAD CELL CHARACTERISTICS		US CAPACITIES	SI CAPACITIES
#	CAPACITY	100K (lbf)	450 (kN)
1	OUTSIDE DIAMETER	Ø8.00 (Ø203.1)	
2	MOUNTING BOLT OFFSET ANGLE	11.25°	
3	BASE PAD HEIGHT	0.03 (0.8)	
4	BASE PAD DIAMETER	Ø3.00 (Ø76.2)	
5	(4) SPANNER HOLES SPACED AT 90°	Ø0.31 ∇ 0.31 (Ø7.9 ∇ 7.9)	
6	BASE THREAD, DEPTH & COUNTERBORE	1.750-12 UN-3B ∇ 1.75 □ Ø1.77 ∇ .12	M42 X 2-4H ∇ 44.4 □ Ø42.5 ∇ 3.0
7	THREAD ADAPTOR & SPANNER NUT	CA-103	CA-203
8	ADAPTOR THREAD	1.750-12 UN-3A	M42 X 2-4g
9	THREAD LENGTH	2.00 (50.8)	
10	HUB SURFACE DIAMETER	Ø3.00 (Ø76.2)	
11	ROTATIONAL CLEARANCE (CONNECTOR)	R4.50 (R114.3) MIN	
12	CONNECTOR TYPE	PT02E-12-8P	
13	FLEXURE & BASE OVERALL HEIGHT	4.25 (108.0)	
14	OVERALL LENGTH	8.75±.12 (222.2±3.1)	
15	SPHERICAL RADIUS	12.00 (304.8)	
16	WARNING LABEL		
17	IDENTIFICATION LABEL INCLUDING: MODEL, CAPACITY, SERIAL NUMBER & OUTPUT		

REMOVE BURRS AND SHARP EDGES .02 MAX SURFACE FINISH 63 MICROINCHES	
CREATOR:	DATE:
DESIGNED:	
DETAILED:	12/26/96
PER:	
CAM DATA:	

interface
ADVANCED FORCE MEASUREMENT
7401 E. BUTHERUS DR. SCOTTSDALE, AZ USA 85260

TITLE:
OUTLINE MODEL: 1632

SIZE: A DWG. NO: **80020** REV: **E**

SCALE: 1:3 SHEET 1 OF 1

CAD FILE <N:\-180020E.SLD***>